

MODERN MIRROR INSTALLATION MANUAL & USER GUIDE

 **CAUTION** It is the responsibility of the installer to ensure the product is correctly installed, as per this instruction manual.

Please read instruction manual carefully and refer back to them during installation to ensure this product is fitted safely and that it retains its high quality.

BEFORE INSTALLATION

Please check your goods carefully and ensure all supplied parts are removed from the box prior to disposal.

If your Mirror is damaged, incorrect or faulty, **DO NOT** proceed with installation and get in touch with your store of purchase immediately. No claims for damages or defects will be accepted after this product is installed.

For full warranty terms please visit remer.com.au/warranty

FOR SAFE USE:

- Please read the instructions and warnings carefully before installing this product and ensure this manual is kept for future reference.
- If any modifications are made to this product, it will void the warranty and may render the product unsafe.
- This product is not suitable for use in saunas, steam rooms or shower cubicles.
- Take suitable precautions when handling products.
- Do not install and/or use if product is broken or unsafe.
- We recommend this product be installed by two people.

HANDLING TIPS:

- **Do not place Remer mirrors on hard surfaces.**
- **Always lift with two or more people.**
- Hanging mechanisms may vary depending on the product. Check the supplied brackets before installation.
- Measure and install hanging system on the wall using the appropriate wall fixings for your wall type.

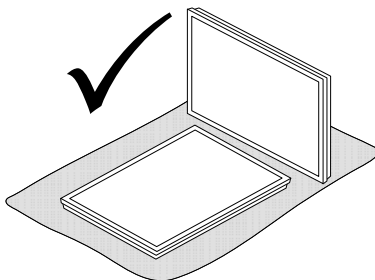
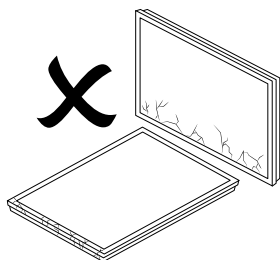

PARTS IN BOX:

1 x Mirror

2 x Brackets

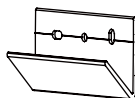

This installation manual applies to all Modern Collection Mirrors.
Mirror shape for illustrative purposes only.

BRACKET INSTALLATION

1.

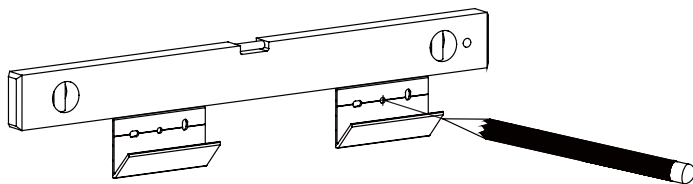

2.

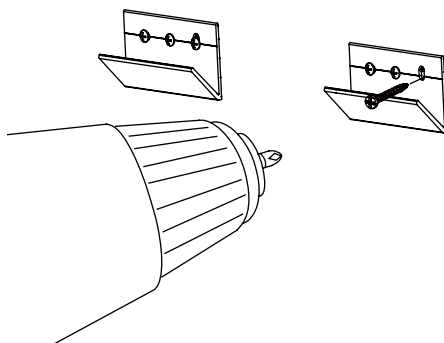

3.

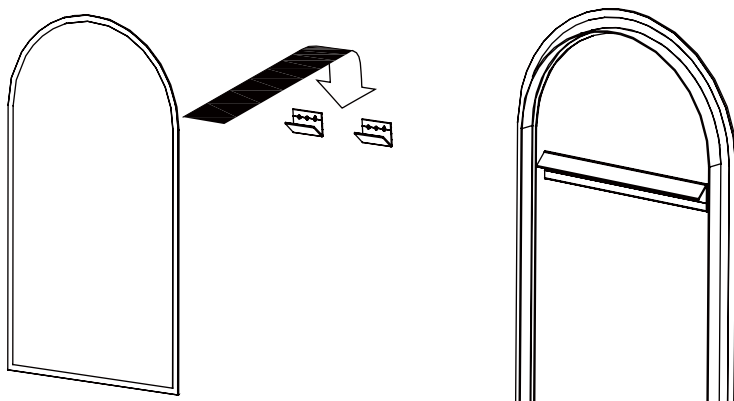

CLEANING AND MAINTENANCE TIPS:

- Please clean mirror surface with a mixture of 10% methylated spirits and 90% water and use a soft micro-fibre cloth/chamois.
- Always use soft-grit-free cloths when cleaning the mirror glass to reduce chances of scratching the surface.
- Be sure to dry all joints and edges of the mirror thoroughly
- Do not use any harsh chemicals or windows cleaners etc.
- To clean Frames, please use a soft microfibre cloth/chamois and warm water only

DO NOT Use any abrasive, acidic or alkaline based solvents or cleaners. Avoid sharp objects and keep heat and hot objects away from all surfaces of any Remer products.

REMER PTY LTD RESERVES THE RIGHT TO MAKE ANY CHANGES IN PRODUCT CHARACTERISTICS, PACKAGING OR AVAILABILITY AT ANY TIME WITHOUT NOTICE. PLEASE VISIT OUR WEBSITE OR CONTACT OUR MELBOURNE BASED CUSTOMER SERVICE TEAM FOR THE LATEST INFORMATION.