

Liano Under Counter

Ceramic Under Counter Vanity Basin

Basin Size: 430mm x 430mm (nominal).

Bowl capacity: 9 litres to overflow.

The **Liano** basins have been designed to meet the needs of the designer market for prestige projects. An architectural minimalist style was adopted for the square **Liano**. The basin is suitable for general purpose applications. The rim is sealed to the underside of the counter top with an acetic cured silicone sealant.

Tap Holes: No tapholes only.

Installation: The **Liano 430** basin is suitable for installation under polyester, marble, natural stone or other suitable impervious materials.

Overflow: Overflow available only. Maximum tap flow rate of 15 litres/minute.

Fixing: Four **Aluminium Clip Brackets** (supplied) for fixing to marble or granite counter tops.

The rim of the basin must be sealed to the underside of the counter top with an acetic cured silicone sealant. **Epoxy type glues must not be used.** Basin supplied with a template which must be used for the counter top cut-out.

Installation: Refer to *Important Information for Plumbers* section.

Colours: White only.

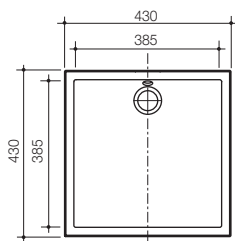

Acetic cured silicone sealant

IMPORTANT:

Epoxy type glues must not be used

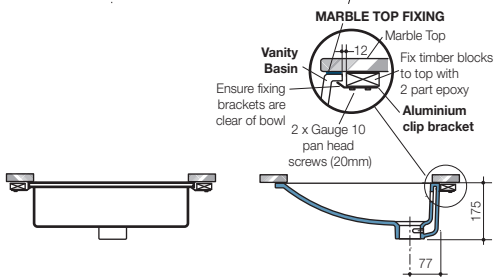

Supplied with chrome flush fitting waste and white plug.