

## Model RBA4157-777-007

### Materials & Features

Designed to support users securely and comfortably, this shower seat is intended to suit the requirements of AS1428.1 when installed correctly. The seat is slip-resistant, self-draining and secured to the frame from underneath to eliminate visible fixings and improve comfort and infection control. The PVD Gunmetal support legs extend to the floor for increased stability and fold away when not required. PVD coating is a premium coating process in which a solid material is vaporised and slowly layered onto a fixture. This results in a durable, versatile finish that's more environmentally friendly than traditional coating methods. Find out more at [rba.com.au/pvd](http://rba.com.au/pvd).



### Technical Detail

Frame: 1.2mm x 25mm x 25mm, 304 stainless steel, PVD Gunmetal finish  
 Seat: One-piece, 12mm phenolic  
 Fixings: By others

**Available Model**  
**RBA4157-777-007**

Folding Shower Seat | PVD Gunmetal

**Related Products**  
**RBA4157-777-006**  
**RBA4806-721**  
**RBA1631-606**

Folding Shower Seat | PVD Brushed Brass  
 Modular Shower T-Rail Kit | PVD Gunmetal  
 enda Accessible Shelf | PVD Gunmetal

### Installation

Warning: Folding Shower Seats are no stronger than the anchors or walls to which they are attached and therefore must be firmly secured in order to support the loads for which they are intended.

**Important:** Installation instructions and current rough-in details should be furnished with each fixture. Do not rough in without certified dimensions. Dimensions are subject to manufacturer's tolerance of +/-10mm. Due to the semi-reflective nature of PVD, colours may appear differently depending on surface shape and lighting conditions. RBA recommends viewing fixtures under the same lighting conditions where they are to be installed.

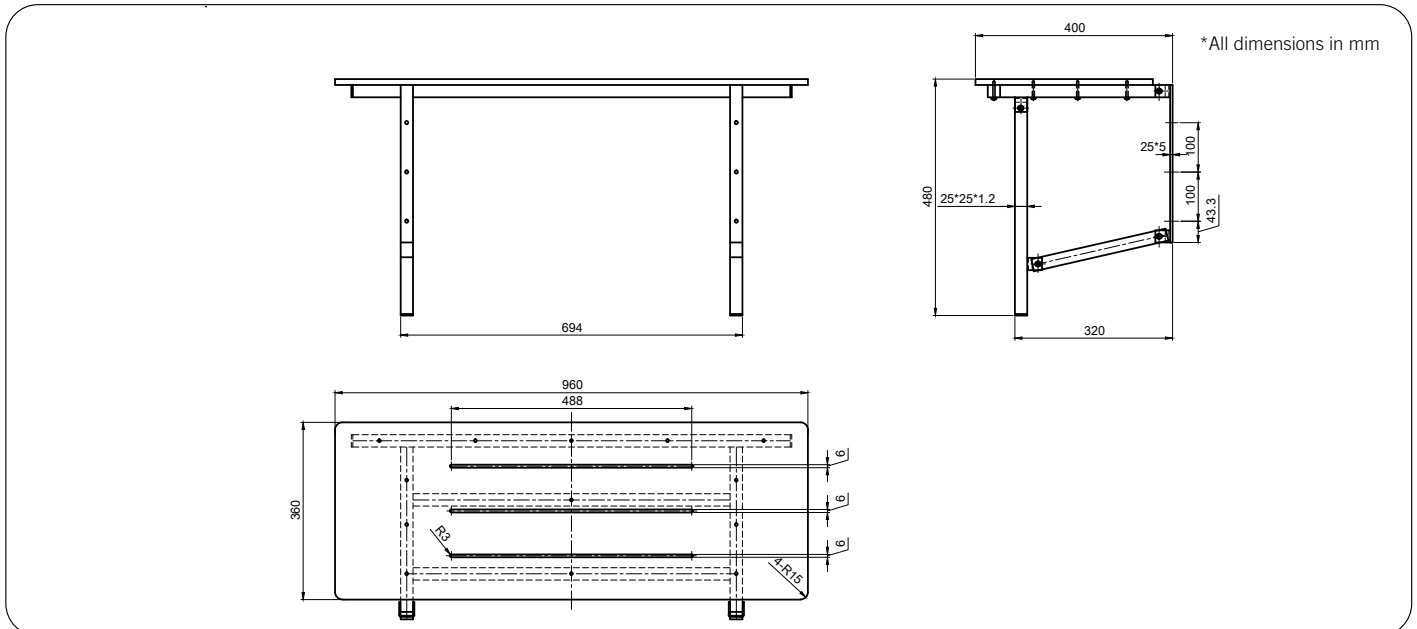

Global-Mark.com.au®  
 Sourced/Supplied under QMS