

# CAROMA

Revision: 0

Date: 27/09/2023

Supersedes all previous issues

## Liano II Sensor Wall Mounted Soap Dispenser

Electronic Hands-Free, Bluetooth® Enabled



# CAROMA

## Liano II Sensor Wall Mounted Soap Dispenser



Combining the aesthetic appeal of the stunning Liano II collection, this new premium sensor tapware range is the perfect balance of design and functionality creating the ultimate statement in your bathroom. The innovative touch-free range is both hygienic and economical with advanced technology ensuring water conservation and optimal germ control for optimal performance in demanding applications.

- Universal In-wall Rough-in Kit included (or can be purchased separately). Rough in first with the in-wall Rough-in Kit. This allows final selection of colour or style to be made later.
- Solid brass construction for durability and reliability in high use applications.
- Contactless dispensing to maintain high hygiene standards.
- Auto shut off to reduce accidental liquid or foam soap waste.
- Infrared sensor provides hands free operation ideal for infection control and hygiene.
- Refillable 1000ml liquid or foam soap bottle.
- Australian designed & engineered.
- Matching sensor taps available.
- Powered by Mains; Supplied with both mains power option or battery powered options. 4 x 1.5V D batteries required (not supplied) Battery box has IP65 rated water resistance.
- Peristaltic pump ensures superior performance with no dripping.
- Remote mounted power supply & pump assembly.
- Foam soap provides a superior handwashing experience with better soap coverage and easier rinsing. The pump control box includes a control knob to adjust the soap dispensing from liquid to foam.
- IP65 water resistant sensor window.

Available Colour Finishes	Outlet Kit Code No.	Trim Kit Code No.	Rough-in Kit Code No.
Chrome	96391C	99681C	
Matte Black	96391B	99681B	
Gunmetal	96391GM	99681GM	99683
Brushed Nickel	96391BN	99681BN	
Brushed Brass	96391BB	99681BB	

Also available in the following colour options:

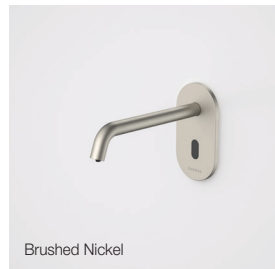
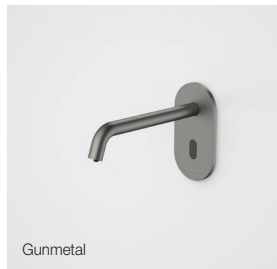
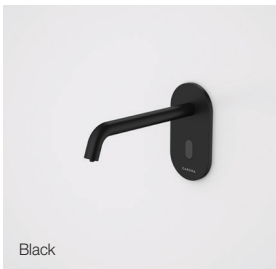

All dimensions are in millimetres and are subject to normal manufacturing variations. Caroma pursues a policy of continuing improvement in design and performance of its products. The right is therefore reserved to vary specifications without notice.

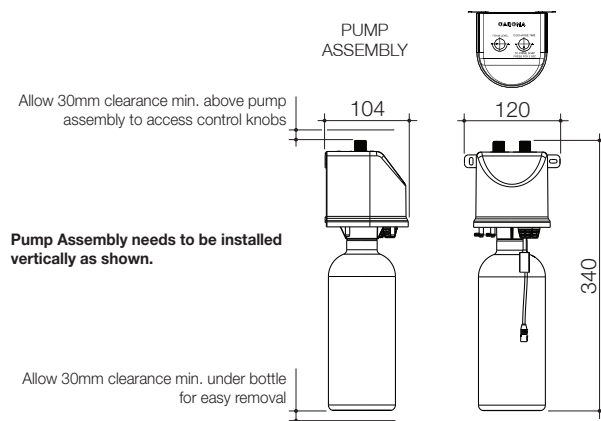
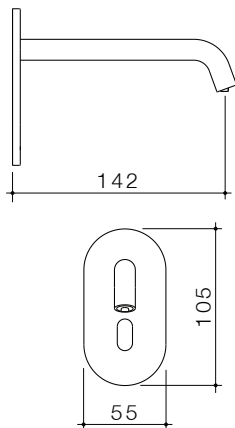
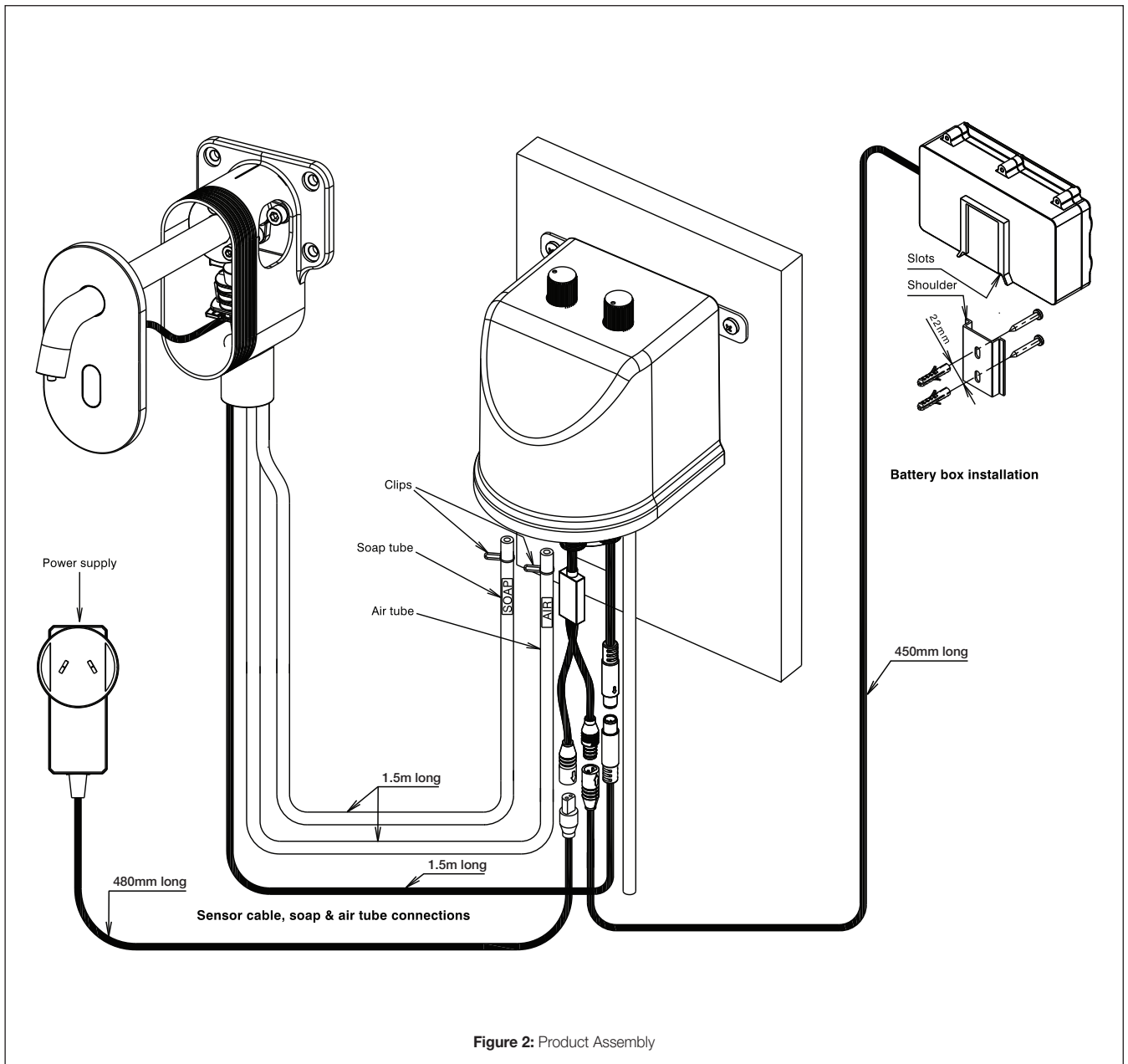

Figure 1: Overall Dimensions



<b>CAROMA</b>	<b>Technical Data</b> <b>Liano II Sensor Wall Mounted Soap Dispenser</b>
<b>Soap Viscosity</b>	Soap solution viscosity should be within 100 to 2500cps. Refer to IMPORTANT INFORMATION for more details.
<b>Power Supply</b>	Wall mounted power pack (supplied)
<b>Sensor Type</b>	Infra-red
<b>Activation Range</b>	140mm (when hand is placed horizontally)
<b>Maximum Power Consumption</b>	<1A
<b>Power Supply Input</b>	240V AC 50/60 Hz
<b>Power Supply Output</b>	6V DC
<b>Power Supply EMC Approvals</b>	CISPR 14
<b>Power Supply Safety Approvals</b>	SAA
<b>Power Supply Safety Compliance</b>	AS/NZS 61558
<b>ROHS Compliance</b>	EN50581:2012
<b>EMC Compliance</b>	IEC61000-3-2, IEC61000-3-3, CISPR 14-1
<b>Electrical Safety Compliance</b>	IEC 60950-1
<b>Complies with EC Directives</b>	2014/30/EU, 2011/65/EU
<b>Battery Information</b>	Battery capacity: 1500mAh; Battery type: D; Battery lifetime: 3 months (if used on average 150 times per day)
<b>IMPORTANT INFORMATION</b>	<p>Do not install this unit facing a mirror or any other electronic system operated by an infra-red sensor. To prevent reflection problems, it is recommended to keep a minimum distance of 1.5m between the soap dispenser and any other objects. Wearing high-vis clothing in front of the sensor can also cause accidental sensor activation.</p> <p>The sensor window height is 18mm from the base and needs a clear space in front to operate properly. If the soap dispenser is to be installed behind an inset basin and the sensor window will be blocked, a matching riser piece can be purchased to raise the soap dispenser higher by 60mm.</p> <p>Both water based and non-water based soap solutions can be used. Soap solution viscosity should be within 100 to 2500cps. For high viscosity soap solutions, the foam level knob must be set to minimum at '-' no air to enable smooth dispensing. For water based solutions, the foam level knob must be turned anti-clockwise towards '+' max. air.</p> <p>Soap control unit must be primed before first use and after every refill.</p>